

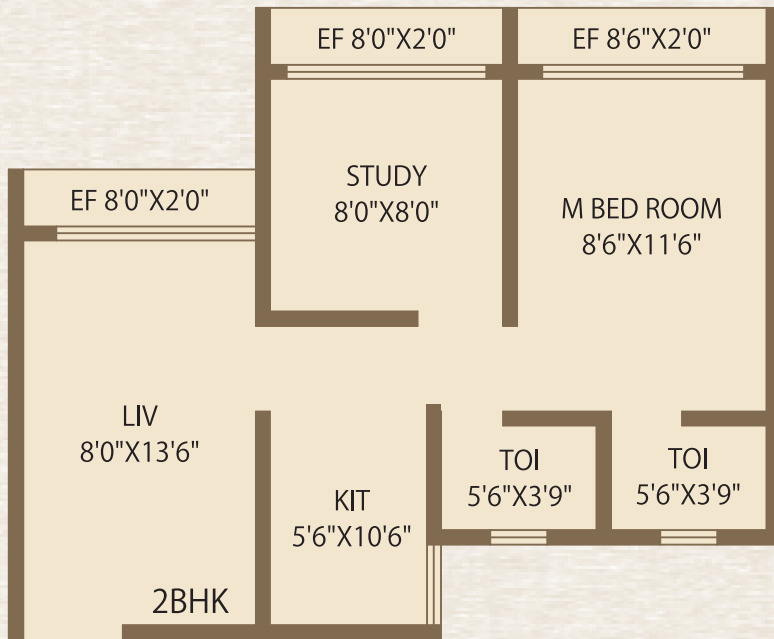

Property
Investment
Now So
Simple

with Option to Purchase



▶ Invest 50% of Flat Cost ◀

Get Rent
Rs. 7,300/-
Monthly

| | | | |
|------------------|-----|--------------------------------|----------|
| Area Description | 700 | RERA CARPET | = 399.76 |
| | | ELEVATION FEATURES | = 48.54 |
| | | TOTAL USEABLE AREA | = 448.30 |
| | | STAIR+LOBBY+OTHER | = 252.71 |
| | | TOTAL CONSTRUCTION AREA | = 700.00 |

Proposed Launching On or before 18 Months - Rs. 42.35 Lacs Minimum.

Investor's privilege Price - Rs.35.00 Lacs - till Completion of Plinth

| | | | | | | |
|---|---|--|---|--|---|--|
| Investment Amount (50%) Rs.17,50,000/- | Receive Monthly Rs.7,292/- through 18 PDCs | Min Gross Sale Benefit Rs.7.35 Lacs | Total Received by Monthly Benefit Rs.1.31 Lacs (A) | Net Sale Benefit 50:50 Rs.6.03 Lacs | Investor's Profit Share Rs.3.01 Lacs (B) | Developer's Profit Share Rs.3.01 Lacs |
|---|---|--|---|--|---|--|

Investor's Minimum Net Benefit Rs.4.33 Lacs (A+B)

घर हो तो ऐसा®

Original... Since 1998

*Above Figures and Plan are Indicative, only for investors survey before launch of fully furnished flat.